

## **DOMINATOR***PLUS*

# *G3840F Single Pan Fryer with Filtration*

### Key features

- Energy efficient, high performance burner
  - Quick heat up and recovery times
- Automatic two-stage filtration built in
  - Increases oil longevity and maintains quality
- Stainless steel hob with mild steel pan
  - Robust construction to withstand busy demands
- Temperature range between 140 - 190°C
  - Variable, precise control
- Sediment collection zone
  - Keeps all cleaner for longer
- Electric ignition to burner
  - Quick and easy lighting
- Fast-acting safety thermostat
  - Power cut to unit if oil overheats
- Supplied with fish grid, basket and lid
  - Everything you need to start frying
- Supplied with drain bucket, strainer and filter
  - Essential parts of the filtration process
- Laser-etched control icons
  - Permanent, indelible markings

### Accessories

- Sidescreens
- Factory fitted, adjustable castors
- Fixed installation kit

### Similar Models

- E3840 Single pan, twin basket electric fryer
- G3860F Single pan, twin basket fryer with filtration
- G9341F Single pan, twin basket fryer with filtration
- E3840F Single pan, twin basket electric fryer with filtration



# Single Pan Fryer with Filtration

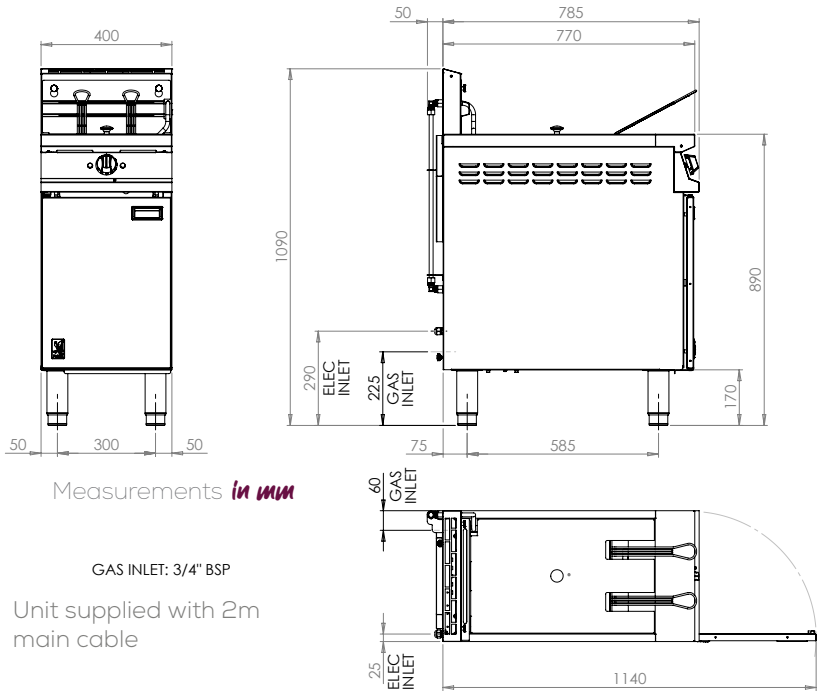

Measurements *in mm*

GAS INLET: 3/4" BSP

Unit supplied with 2m main cable

Unit on castors is the same hob height

## Installation notes

Adequate ventilation must be provided to supply sufficient fresh air for combustion and to allow easy removal of any such products that may present a risk to health. Please consult current legislation for details that relate to specific locations.

Install unit on a level, fireproof surface in a well-lit, draught free position. If floor is made of a combustible material, local fire requirements must be checked to ensure compliance.

A clearance of 150mm should be observed between appliance and any combustible wall.

## Specification *details*

Total rating (natural and propane - kW - Nett)	22		
Total rating (natural and propane - btu/hr - gross)	82,500		
Electrical supply voltage	230V N~		
Inlet size (natural and propane)	3/4" BSP		
Flow rate - natural (m <sup>3</sup> /hr)	2.33		
Flow rate - propane (kg/hr)	1.57		
Inlet pressure (natural and propane - mbar)	20 / 37		
Operating pressure (natural and propane - mbar)	14 / 34.6		
Oil capacity (litres)	18		
Hourly chip output (kg)	34		
Weight (kg)	83		
Packed weight (kg)	94		
Packed dimensions (w x d x h - mm)	450 x 1000 x 1300		
GTIN numbers			
Nat Gas (feet)	Nat Gas (castors)	LPG (feet)	LPG (castors)
5056466902049	5056466902032	5056466902025	5056466902018

