

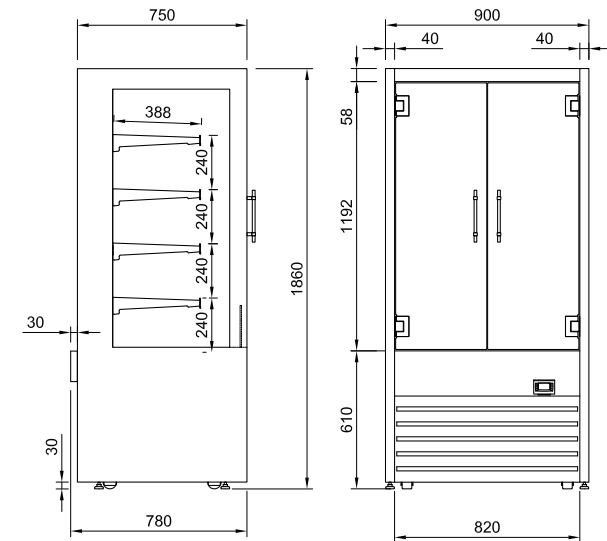

- Stainless steel construction
- Four Stainless steel adjustable shelves
- Ticket strips on shelves
- Shelf mounted air curtains
- Under shelf and canopy LED lights
- Forced air circulation
- Removable front grill panel
- Roll in on castors
- Hinged glass front door

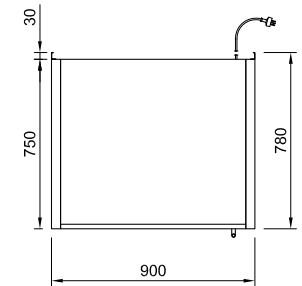

## CABINET DIMENSIONS & SPECIFICATIONS

Prior to installation see, installation guidelines documents

MODEL	CABINET				SHELVING	OPERATING TEMP	SHELF	BASE TRAY	DISPLAY	FREQUENCY	OPERATING CURRENT	ENERGY CONSUMPTION	CONNECTION ELECTRICAL POWER CORD 2200MM		VOLTAGE	PACKED FOR SHIPPING			
	LENGTH [MM]	DEPTH [MM]	HEIGHT [MM]	WEIGHT [KG]									DEG C	W X D		W X D	M <sup>2</sup>	Hz	Amps
DTGHT6	600	780	1860	139	4 + BASE	75 -85	510 X 388	520 x 460	1.02	50/60 HZ	7.2		10 AMP 3 PIN PLUG	13 AMP 3 PIN PLUG	220-240V	700	830	2030	175

Maximum shelf load weight 15kg spread evenly



AutoCAD



Revit



SketchUp

