



F900

i91105C Induction Range with Fan-assisted Oven

Key features

- 4 x 5kW induction heat zones
 - Instant heat, rapid heat up
- In-built pan detection delivers energy savings
 - No wasted energy as no pan = no energy generated
- Low heat emissions
 - Much cooler working environment
- Precise temperature control
 - Instant heat, rapid heat up
- 6mm toughened glass hob
 - Robust enough for the toughest kitchen environments
 - Simply wipes clean - no scrubbing after service
- IPX5 rated
 - Easy and problem-free cleaning

Wide oven temperature range of 80 - 300°C

- Ideal to prepare a wide variety of food

- 2/1 GN fan-assisted oven
 - Even cooking throughout the oven chamber
- Fully pressed metal to metal door seal
 - Keeps heat where it's needed - in the oven chamber
- Oven has 5 shelf positions and allows 2 shelf cooking
 - Versatile, ideal for a wide range of menu items
- Stainless steel panels with Scotch Brite finish
 - Looks great, ideal for front-of-house kitchens

Accessories

- Oven shelf
- Front hob rail
- Kick strip
- Rear blanking plate
- Side hob extension
- Factory fitted, adjustable castors



Similar Models

- i91104 4 x 3.5kW induction range
- i91104C 4 x 3.5kW induction range with fan oven
- i91105 4 x 5kW induction range

- Dynamic Link System compatible
 - Integrated linking system allows quick and easy installation to create a seamless, continuous cookline

F900

i91105C

Induction Range

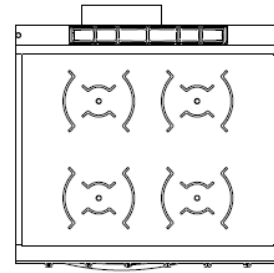
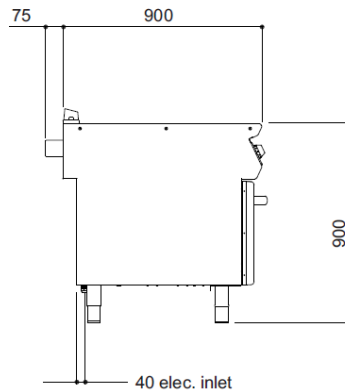
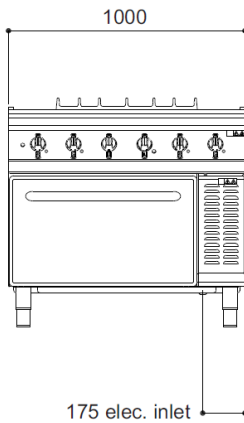

Measurements *in mm*

Unit on castors is the same hob height

Specification details

Electrical rating (kW)	26.4	
Electrical supply voltage	400V 3N~	
Required electrical supply (A)	63	
Electrical current split (A)	L1: 38.6, L2: 38.6, L3: 38.6	
Element rating - hob (kW)	4 x 5	
Element rating - oven (kW)	6.4	
Heat zone diameter (mm)	270	
Minimum pan size (mm)	120	
Oven dimensions (w x d x h - mm)	565 x 730 x 300	
Oven shelf (w x d - mm)	535 x 700	
Gastronorm compatibility	2/1	
Weight (kg)	141	
Packed weight (kg)	164	
Packed dimensions (w x d x h - mm)	1200 x 1000 x 1110	
GTIN numbers	On feet	On castors

Short Form specification

Unit to be Falcon F900 Series induction range with a counter top having 4 x 5kW cooking zones. A 2/1 gastronorm compatible fan-assisted oven will be located below.

The hob will be constructed from 6mm toughened ceramic glass and 2mm 304 grade stainless steel. Hobs will be laser cut with right-angled edges to allow joining of units with no gaps between hobs. Exterior panels are Scotch Brite finish stainless steel. Control knobs to be marked showing zone variable control settings and to have a bezel behind each knob to prevent water ingress. The unit will have IPX 5 water resistance certification.

Unit to be supplied upon adjustable feet or upon optional castors.

Installation note

Please consult local legislation with regard to installation of cooking equipment.



Falcon Foodservice Equipment, Wallace View, Hillfoots Road, Stirling FK9 5PY Scotland
t: +44 (0) 1786 455 200 e: info@falconfoodservice.com www.falconfoodservice.com

i91105C/SS/1120