



OG7502/P - Lincat Phoenix Propane Gas Free-standing Atmospheric Steamer - W 630 mm - 13.0 kW

The Phoenix Atmospheric Steamer is ideal for steaming vegetables, rice, fish and other foods, and has a generous capacity of 6 x 2/1GN.

- ✓ Perfect solution for volume production of healthy steamed food
- ✓ Ideal for steaming vegetables, puddings, rice, ham, fish and a range of other foods.
- ✓ Generous capacity 6 x 2/1GN
- ✓ Six shelf positions and removable shelf supports for maximum versatility
- ✓ Mechanical water control - no electrical requirement
- ✓ 304 grade stainless steel oven interior for long service life
- ✓ Thermostatic control and boil dry protection for trouble free operation

Specifications

Summary

Brand	Lincat
Range	Phoenix
Power Type	Gas
Gas Type	Propane Gas
Unit Type	Free-standing
Available in UK Only	No
UK Warranty	2 Years Parts and Labour Warranty
Export Warranty	Contact your local dealer
GTIN	5056105109808

Power and Performance

BTU per Hour	44,356
Total Power kW	13
Temperature Control	Mechanical
Oven Rating kW	13

Key Specifications

Number of Shelves included	6
Number of Shelf Positions	6

Capacity

Gastronorm Capacity	6 x GN2/1 [12 x GN1/1]
----------------------------	------------------------

Weights and Dimensions

Unit Height (External) mm	1620
Unit Width (External) mm	630
Unit Depth (External) mm	970
Height (Internal) mm	680
Width (Internal) mm	555
Depth (Internal) mm	650
Shelf Dimensions Width mm	530
Shelf Dimensions Depth mm	650
Net Weight Kg	123

Supply Connections

Requires Installation	Yes
Requires Electrical Supply	No
Gas Connection BSP	1/2"
Gas Consumption at full rate Propane m³ per Hour	0.93
Gas Pressure Propane mbar	25
Total heat input at full rate Propane kW	13
Total heat input at full rate Propane BTU per hour	44,356
Water Connection Pressure Bar	0.2-10.0
Drain Connection	15 mm
Water Connection	15 mm

Shipping

Packed Weight Kg	181.5
Packed Height cm	180
Packed Width cm	115
Packed Depth cm	76

Available Accessories

- CH01 Caterflex Hose 1/2" - 1 Metre - for use with units up to 66,000 BTU
- CH02 Caterflex Hose 1/2" - 1.5 Metre - for use with units up to 56,000 BTU

Technical Picture

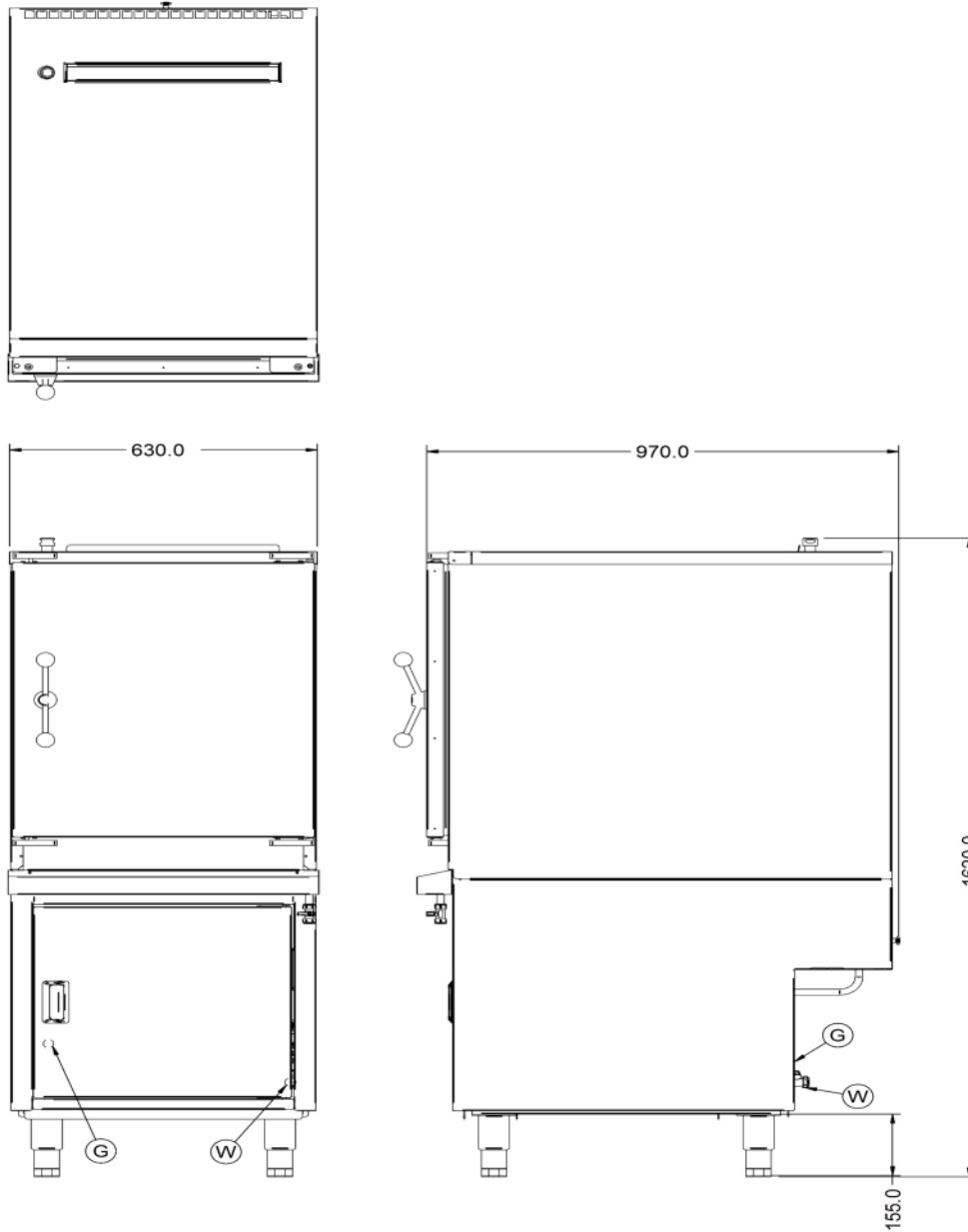



Lincat Limited

Whisby Road,
Lincoln, LN6 3QZ,
United Kingdom

Company No: 2175448

A member company of



Customer Care

Tel: +44 1522 875500
Email: care@lincat.co.uk

Export Customers

Tel: +44 1522 875536
Email: export@lincat.co.uk

Opening Hours

Monday – Friday:
8.30am – 5pm