



OG7502/N - Lincat Phoenix Natural Gas Free-standing Atmospheric Steamer - W 630 mm - 13.0 kW

The Phoenix Atmospheric Steamer is ideal for steaming vegetables, rice, fish and other foods, and has a generous capacity of 6 x 2/1GN.

- ✓ Perfect solution for volume production of healthy steamed food
- ✓ Ideal for steaming vegetables, puddings, rice, ham, fish and a range of other foods.
- ✓ Generous capacity 6 x 2/1GN
- ✓ Six shelf positions and removable shelf supports for maximum versatility
- ✓ Mechanical water control - no electrical requirement
- ✓ 304 grade stainless steel oven interior for long service life
- ✓ Thermostatic control and boil dry protection for trouble free operation

Specifications

Summary

| | |
|-----------------------------|-----------------------------------|
| Brand | Lincat |
| Range | Phoenix |
| Power Type | Gas |
| Gas Type | Natural Gas |
| Unit Type | Free-standing |
| Available in UK Only | No |
| UK Warranty | 2 Years Parts and Labour Warranty |
| Export Warranty | Contact your local dealer |
| GTIN | 5056105109792 |

Power and Performance

| | |
|----------------------------|------------|
| BTU per Hour | 44,356 |
| Total Power kW | 13 |
| Temperature Control | Mechanical |
| Oven Rating kW | 13 |

Key Specifications

| | |
|-----------------------------------|---|
| Number of Shelves included | 6 |
| Number of Shelf Positions | 6 |

Capacity

| | |
|----------------------------|------------------------|
| Gastronorm Capacity | 6 x GN2/1 [12 x GN1/1] |
|----------------------------|------------------------|

Weights and Dimensions

| | |
|----------------------------------|-------|
| Unit Height (External) mm | 1620 |
| Unit Width (External) mm | 630 |
| Unit Depth (External) mm | 970 |
| Height (Internal) mm | 680 |
| Width (Internal) mm | 555 |
| Depth (Internal) mm | 650 |
| Shelf Dimensions Width mm | 530 |
| Shelf Dimensions Depth mm | 650 |
| Net Weight Kg | 161.5 |

Supply Connections

| | |
|---|----------|
| Requires Installation | Yes |
| Requires Electrical Supply | No |
| Gas Connection BSP | 1/2" |
| Gas Consumption at full rate Natural m³ per Hour | 1.24 |
| Gas Pressure Natural mbar | 16 |
| Total heat input at full rate Natural kW | 13 |
| Total heat input at full rate Natural BTU per hour | 44,356 |
| Water Connection Pressure Bar | 0.2-10.0 |
| Drain Connection | 15 mm |
| Water Connection | 15 mm |

Shipping

| | |
|-------------------------|-------|
| Packed Weight Kg | 181.5 |
| Packed Height cm | 180 |
| Packed Width cm | 115 |
| Packed Depth cm | 76 |

Available Accessories

- CH01 Caterflex Hose 1/2" - 1 Metre - for use with units up to 66,000 BTU
- CH02 Caterflex Hose 1/2" - 1.5 Metre - for use with units up to 56,000 BTU

Technical Picture

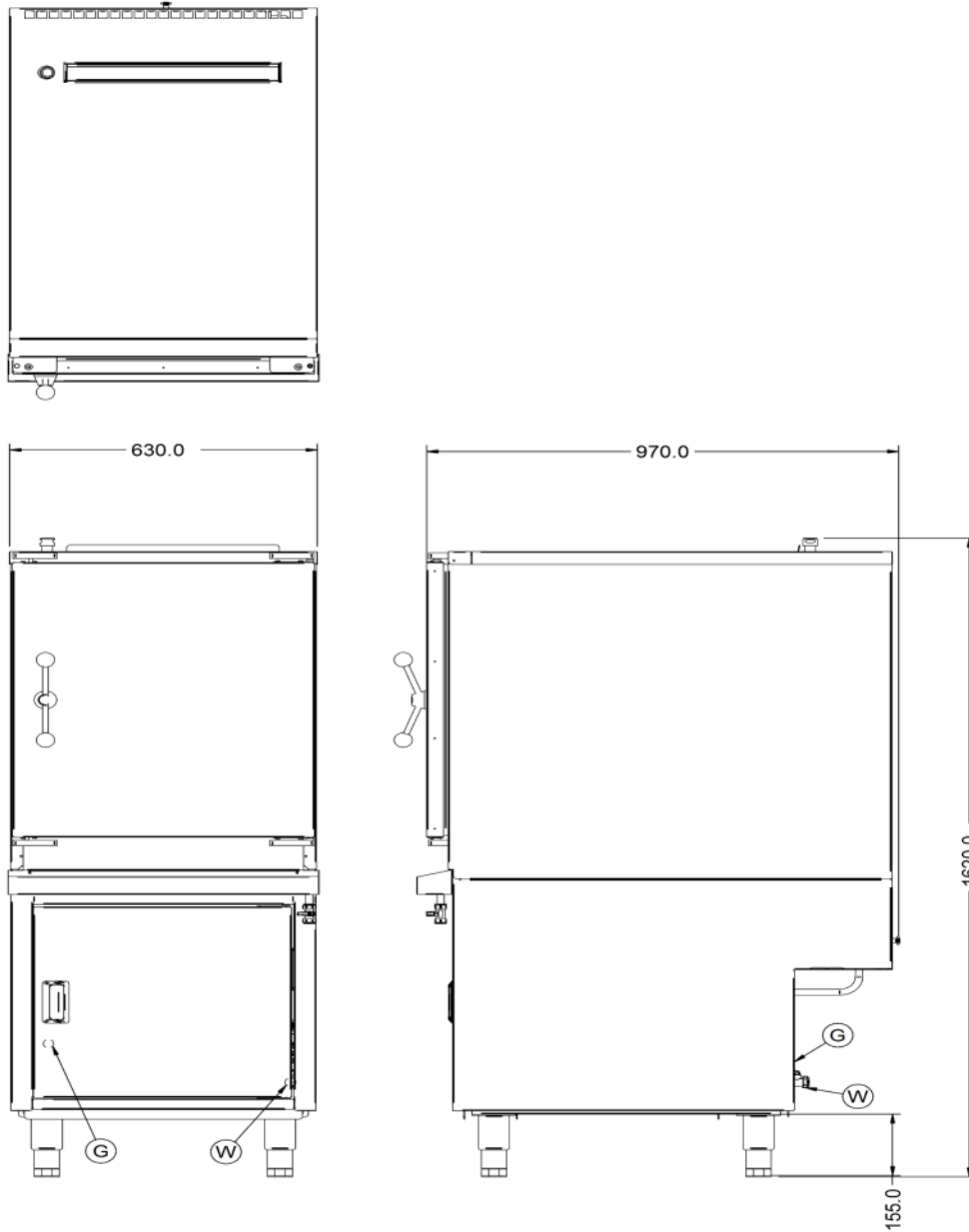



Lincat Limited

Whisby Road,
Lincoln, LN6 3QZ,
United Kingdom

Company No: 2175448

A member company of



Customer Care

Tel: +44 1522 875500
Email: care@lincat.co.uk

Export Customers

Tel: +44 1522 875536
Email: export@lincat.co.uk

Opening Hours

Monday – Friday:
8.30am – 5pm