



# ColdKit

Project Distribution Ltd  
 Unit 1 Sun Street, Stoke on Trent ST1 4JW  
 Tel:01782 280289 Fax: 01782 215955  
 www.prodis.co.uk sales@project-distribution.co.uk

Project

Location

Item#

QTY

Model:  
A10C

Coldkit Araya A10C  
1 Metre, Curved Glass, Serve Over Counter

## Technical Drawing

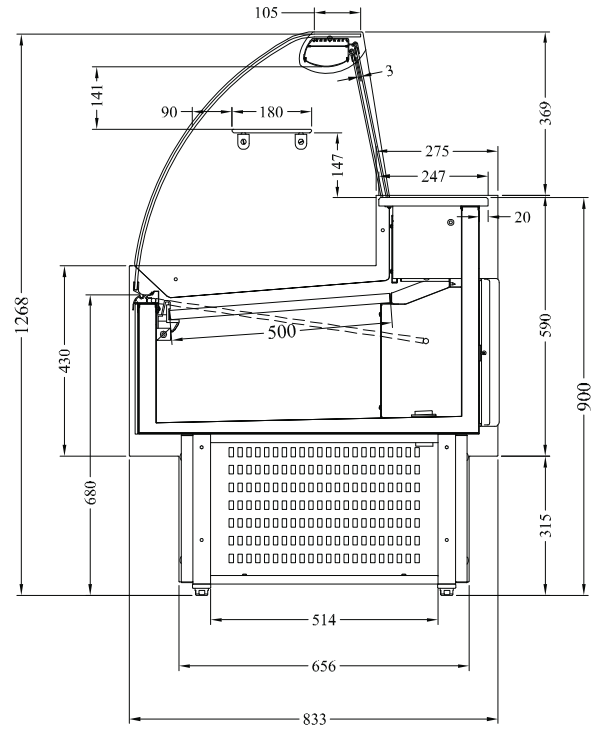
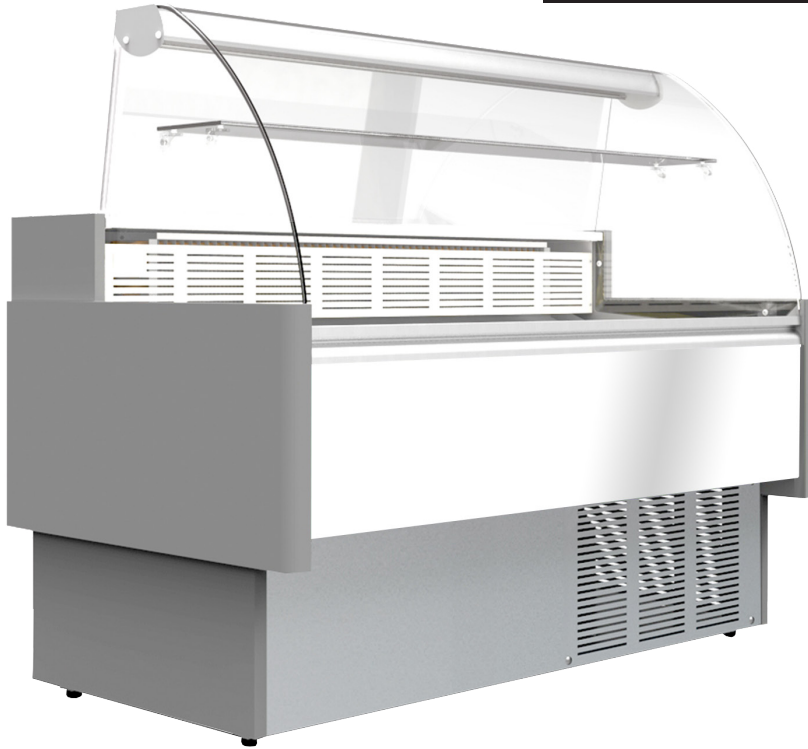

### Key Features

### Construction

### Available Options

- +1°C to +10°C temperature range
- Digital temperature control
- Refrigerated under storage
- Ambient intermediate shelf
- Lightweight design, easy to install
- Digital temperature control
- Digital temperature display
- Illuminated display deck
- 500mm deep deck
- Switchable static or fan assisted cooling
- Fog resistant glass
- Suitable up to 30°C ambient
- R404a refrigerant

- Painted steel construction
- Curved glass design

- Any RAL colour front panel
- Perspex rear doors
- Stainless steel deck
- Step deck

## Technical Data

Model	A10C
Capacity	160 Litres
Display Area	0.61m <sup>2</sup>
Intermediate shelf dimensions	902 x 180
External Dimensions	Width = 1000 Depth = 833 Height = 1268
Interior Finish	White
Exterior Finish	Grey / White
Rear Storage Doors	1
Internal Lighting	✓
Internal Lighting Type	Flourescent
Light switch	✓
Light switch position	Externally mounted
Temperature control	Digital
Temperature control position	External
Temperature range	+1° to +10°c
Refrigerant	R404a

Approvals

Available At

Document #

